

507, 508 & 510 Mullions

ITEM	PART NO	SPECIFY	DESCRIPTION
1	409F836	600	1 - Top Plate with Set Screw
2	220F82 7		4 - Top Plate Mounting Screw 1/4-20" x 1" FHM-PH
3	405F458 464F028 606F058	600 600 600	1 - Mullion up to 7-1/2' Door 1 - Mullion up to 8' Door 1 - Mullion up to 10' Door
8	405F49 6	600	1 - Bottom Plate with Set Screw
9	405F31 8		2 - Floor Anchor Screw 3/8-16" x 1" FHM-PH
10	405F42 8		2 - Floor Anchor

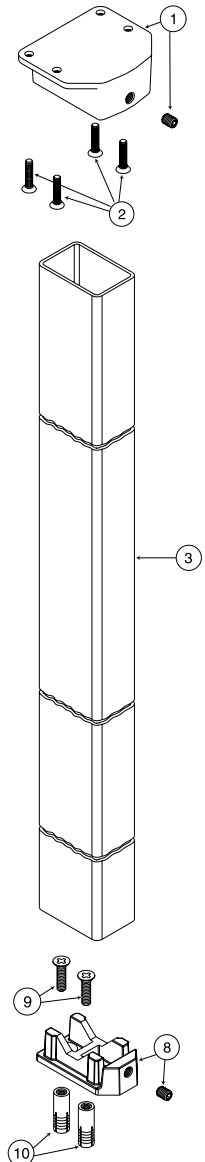

707A, 708A, 710 Mullions & KM Option

ITEM	PART NO	DESCRIPTION
1		Mullion only
	655F50-8	7' for 707A
	655F51-8	8' for 708A
	655F52-8	10" for 710
2	655F60-8	Upper Mounting Bracket
3	655F61-8	Lower Mounting Bracket
4	655F62-8	Anchor Pad
5	655F65-8	Screw Pack contains: Screw # 12-24 x 3/4" FHM-PH (4) Set Screw 5/16 - 18 x 3/8" (1) Set Screw, Half Dog (2) 5/16 - 18 x 5/8" Screw 1/4 - 20 x 3/4" RHM-PH (2) Lock Washer 1/4" (2) Masonry Anchor 1/4 - 20 (2)
6	655F63-8	Angle Bracket Packet (optional) contains: Angle Bracket (1) Screw # 12-24 x 7/16" OHM-PH (2)
7	653F11-1	Stabilizer Kit (optional) contains: Stabilizer Brackets (2) Stabilizers (2) Stabilizer Spacers (4) Screw #10-24 x 3/4" FHM-PH (4) Screw #10-24 x 1" FHM-PH (4)
	655F18-8	Parts Packet contains: Items 2, 3, 4, and 5
8	685F20-8	Keyed Removable Mullion Retro-Fit Kit (cylinder not included unless specified)

